

NEW

CHAIN CLAMPS

**→ The easiest,
→ fastest
→ and safest way
to hold round work pieces**

CHAIN CLAMPS

Chain Clamp

The easiest, fastest and safest way to hold round work pieces for up to 1" bolts or 1 1/8" T-Slots



Clamping Force: **Up to 13,000 lbs (60 kN)**

Application Examples:

Machining of round or cylindrical work pieces, such as valve bodies, flanges, pump housings, pistons etc.

- Great clamping force through little torque
- Easy installation and easy adjustment through stepless adjustable MO-Clamps
- Protects the T-Slot (199-... only)
- Chain links do not have to be taken out when clamping different sized parts
- Parts can be clamped parallel (198-...) or at an angle to the T-Slot (199-...)
- Great for repetitive work, because chain does not have to be dismantled (stays on fixing elements)
- Can be easily fit to different sized machine tables, T-Slots or Tapped Holes
- Uniform clamping force distribution reduces work-piece distortion

Chain: Tempered Steel
Chain Lock: Tempered Steel
Clamping Shoe: Hardened alloy Steel
Clamping Arm: Drop forged alloy Steel

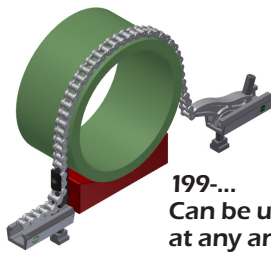
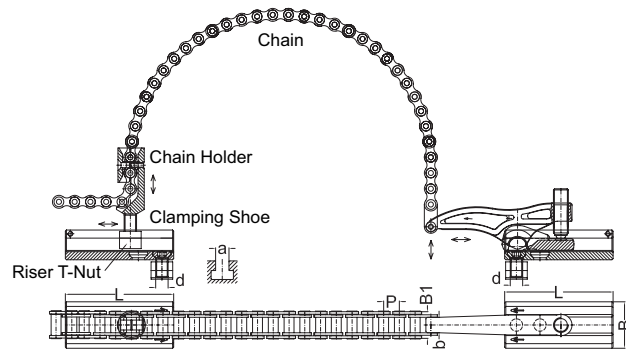

199-...
Can be used parallel and at an angle to the T-Slot

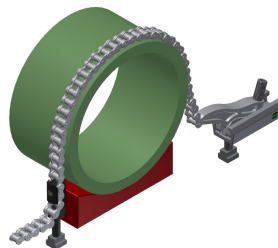

198-...
Can be used parallel to the T-Slot

Metric

Part Number (w/o fixing set)	Bolt Size (d)	T-Slot Size (a)	Chain Length	Chain Pitch (P)	Clamping Force	b	B1	L	B
199-019-0000-13	M10	12	100 – 5000	3/4"	5,600 lbs 25 kN	11.7	22.7	135	52
	M12	14							
	M12	16							
199-019-0000-17	M14	16	200 – 5000	3/4"	6,700 lbs 30 kN	11.7	22.7	155	60
	M16	18							
	M16	20							
199-025-0000-21	M18	20	300 – 5000	1"	11,000 lbs 50 kN	17.0	36.0	175	75
	M20	22							
	M20	24							
199-031-0000-25	M22	24	500 – 5000	1 1/4"	13,000 lbs 60 kN	19.6	43.0	205	88
	M24	28							
	M24	36							

Other sizes available