

NEW

CHAIN CLAMPS

**→ The easiest,
→ fastest
→ and safest way
to hold round work pieces**

CHAIN CLAMPS

Chain Clamp

The easiest, fastest and safest way to hold round work pieces for up to 1" bolts or 1 1/8" T-Slots



Clamping Force: **Up to 13,000 lbs (60 kN)**

Application Examples:

Machining of round or cylindrical work pieces, such as valve bodies, flanges, pump housings, pistons etc.

- Great clamping force through little torque
- Easy installation and easy adjustment through stepless adjustable MO-Clamps
- Protects the T-Slot (199-... only)
- Chain links do not have to be taken out when clamping different sized parts
- Parts can be clamped parallel (198-...) or at an angle to the T-Slot (199-...)
- Great for repetitive work, because chain does not have to be dismantled (stays on fixing elements)
- Can be easily fit to different sized machine tables, T-Slots or Tapped Holes
- Uniform clamping force distribution reduces work-piece distortion

Chain: Tempered Steel
Chain Lock: Tempered Steel
Clamping Shoe: Hardened alloy Steel
Clamping Arm: Drop forged alloy Steel

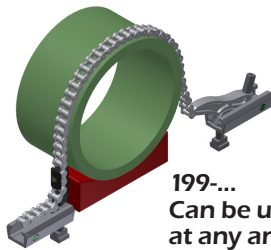
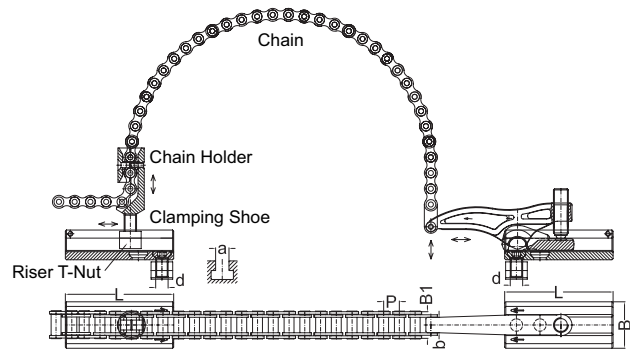

199-...
Can be used parallel and at any angle to the T-Slot

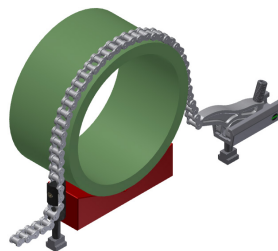

198-...
Can be used parallel to the T-Slot

Inch

Part Number (w/o fixing set)	Bolt Size (d)	T-Slot Size (a)	Chain Length	Chain Pitch (P)	Clamping Force	b	B1	L	B
199-019-0000-13	3/8"	7/16" to 9/16"	3.9 – 196.9"	3/4"	5,600 lbs (25 kN)	0.46"	0.89"	5.31"	2.05"
199-019-0000-13	1/2"	9/16" to 11/16"	3.9 – 196.9"	3/4"	5,600 lbs (25 kN)	0.46"	0.89"	5.31"	2.05"
199-019-0000-17	5/8"	11/16" to 13/16"	7.9 – 196.9"	3/4"	6700 lbs (30 kN)	0.46"	0.89"	6.1"	2.36"
199-025-0000-21	3/4"	13/16" to 1 1/16"	11.8 – 196.9"	1"	11,000 lbs (50 kN)	0.67"	1.42"	6.89"	2.95"
199-031-0000-25	7/8"	1" to 1 5/16"	19.9 – 196.9"	1 1/4"	13,000 lbs (60 kN)	0.77"	1.69"	8.07"	3.46"
199-031-0000-26	1"	1 1/16" to 1 5/16"							
199-031-0000-32	1 1/4"	1 3/8"	19.9 – 196.9"	1 1/4"	13,000 lbs (60 kN)	0.77"	1.69"	8.07"	3.46"

Other sizes available