

# Side Clamp SK10 User Manual

**Content:**

*Standard Face 006-..-1:*

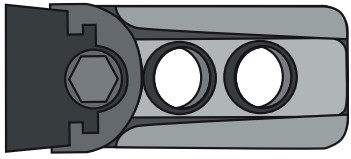

or

*Reversible Face 006-..-2:*

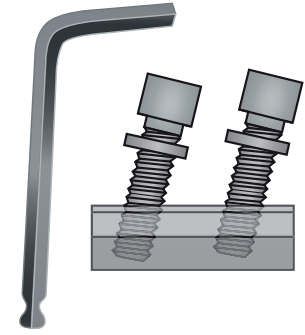
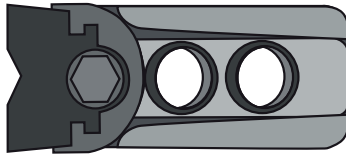

**Operation:**

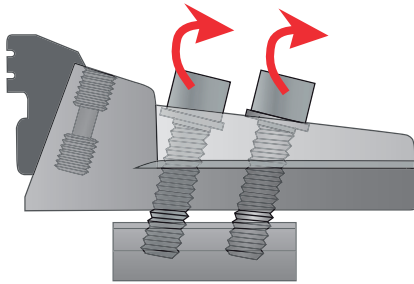

1

**Top View:**

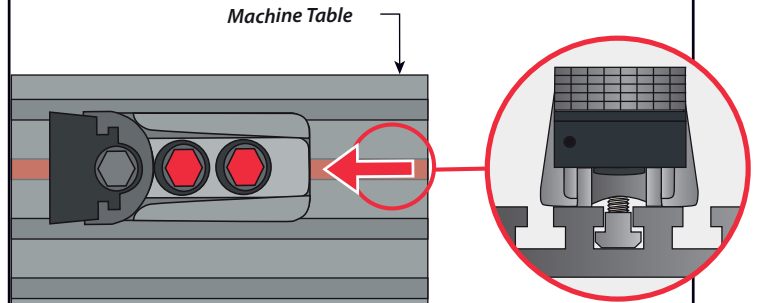

2

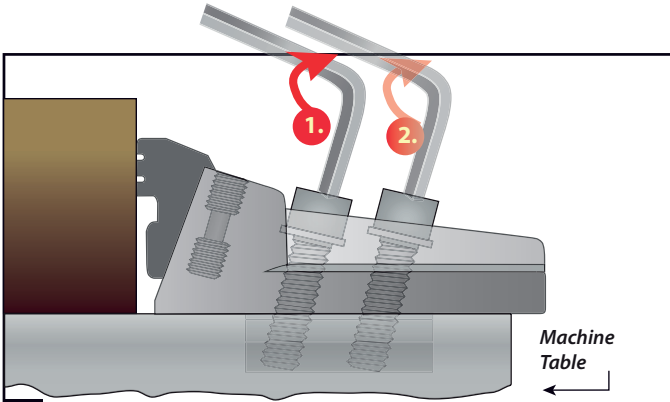

3

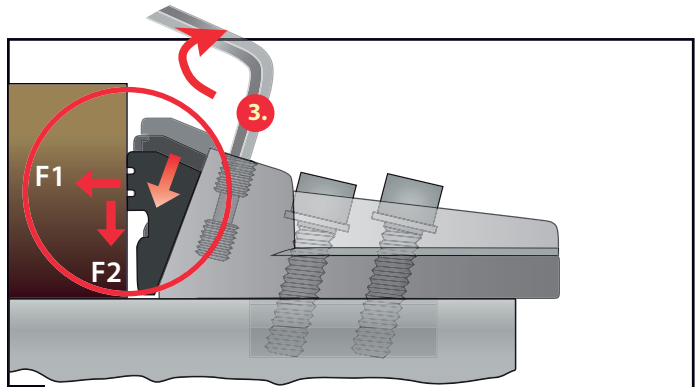

4

**Application SK:**

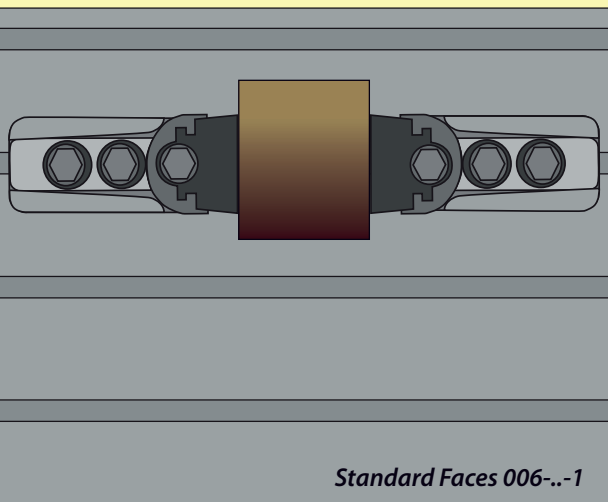

*Standard Faces 006-..-1*

**Application SKQ:**

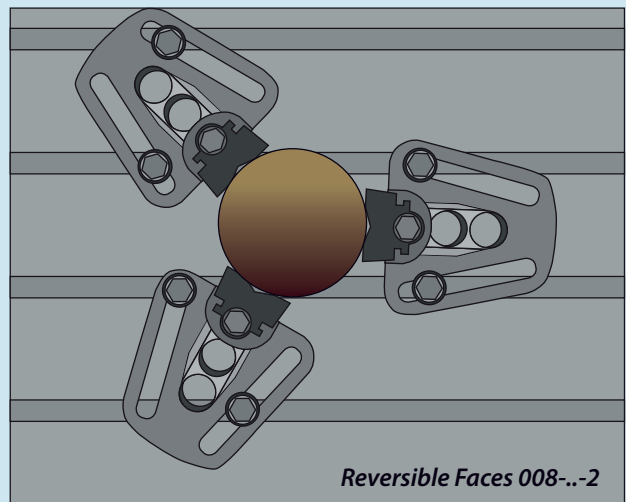

*Reversible Faces 008-..-2*

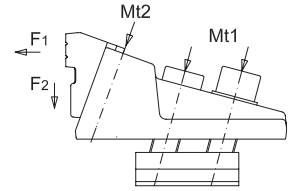

## Side Clamp SK10

### Imperial

Series: Side Clamps SK10 · Recommended Torques (friction = 0.14)						
Item	Fixing Screw (d)		Torque Fixing Screw (Mt 1)	Torque Driving Ring (Mt 2)	Holding Force max. F1	Holding Force max. F2
	inch	metric	ft-lbs	ft-lbs	lbs	lbs
...-013-.....	5/16	M08	22	59	4,400	2,200
...-013-.....	3/8	M10	33	59	4,400	2,200
...-013-.....	1/2	M12	59	59	4,400	2,200
...-017-.....	1/2	M12	59	59	5,600	2,600
...-017-.....	-	M14	92	88	5,600	2,600
...-017-.....	5/8	M16	118	88	5,600	2,600
...-021-.....	5/8	M16	118	88	8,900	4,400
...-021-.....	-	M18	184	147	8,900	4,400
...-021-.....	3/4	M20	250	147	8,900	4,400
...-025-.....	3/4	M20	250	147	14,600	7,100
...-025-.....	7/8	M22	309	221	14,600	7,100
...-025-.....	7/8	M24	398	221	14,600	7,100

### Metric

Series: Side Clamps SK10 · Recommended Torques (friction = 0.14)					
Item	Fixing Screw d	Torque Fixing Screw (Mt 1)	Torque Driving Ring (Mt 2)	Holding Force max. F1	Holding Force max. F2
		Nm	Nm	kN	kN
...-013-.....	M08	30	80	20	10
...-013-.....	M10	45	80	20	10
...-013-.....	M12	80	80	20	10
...-017-.....	M12	80	80	25	12
...-017-.....	M14	125	120	25	12
...-017-.....	M16	160	120	25	12
...-021-.....	M16	160	120	40	20
...-021-.....	M18	250	200	40	20
...-021-.....	M20	340	200	40	20
...-025-.....	M20	340	200	65	32
...-025-.....	M22	420	300	65	32
...-025-.....	M24	540	300	65	32

We reserve the rights to make technical changes